

Appendix 1: Site Maps

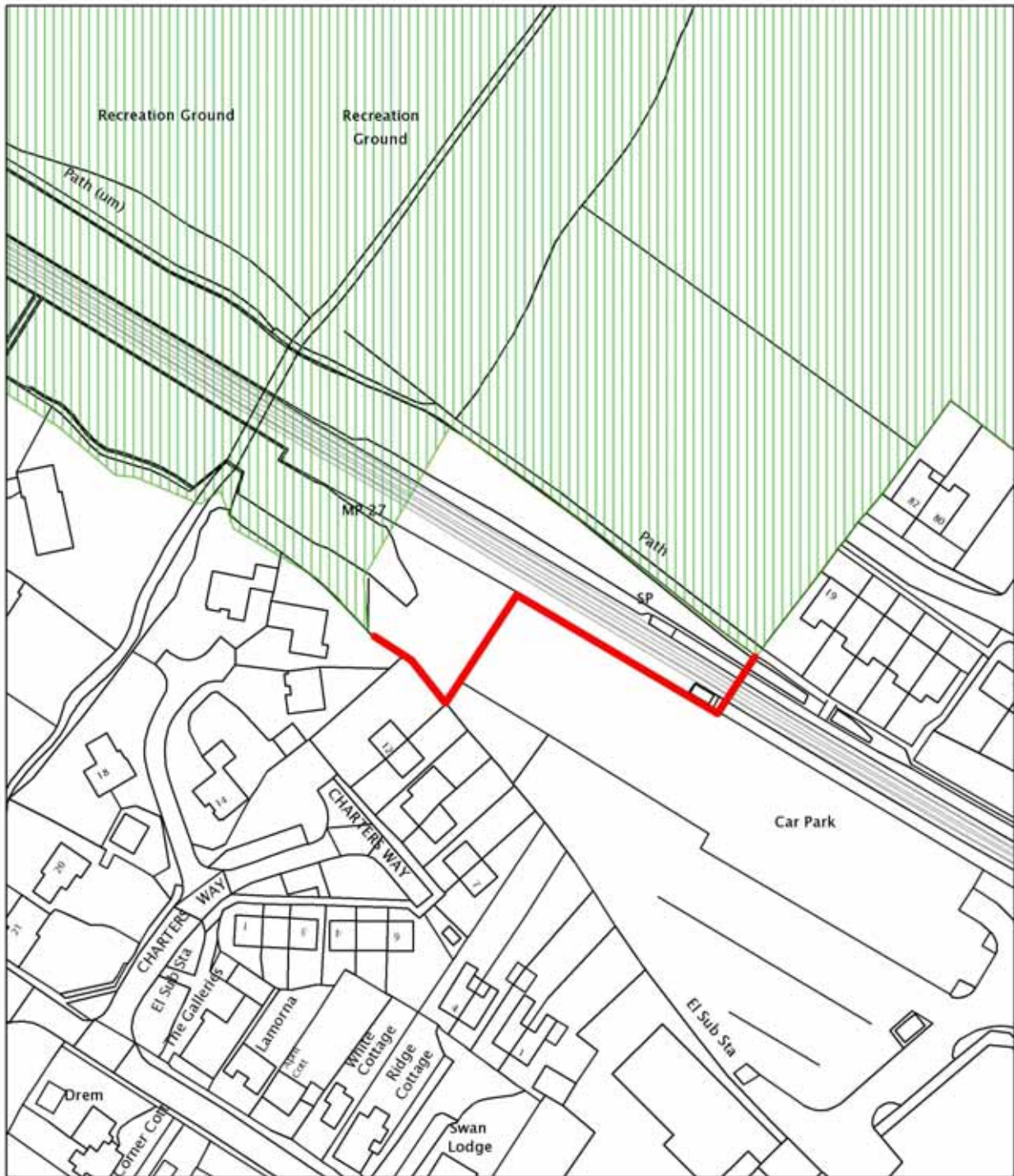

<p>Planning</p> <p>Scale: 1:1,250</p>		<p>Location SD3</p> <p>Land adjacent to station car park, Sunningdale</p>	
<p><small>This map is reproduced from Ordnance Survey material with the permission of Ordnance Survey on behalf of the Controller of Her Majesty's Stationery Office © Crown copyright.</small></p> <p><small>Unauthorised reproduction infringes Crown copyright and may lead to prosecution or civil proceedings. Royal Borough of Windsor and Maidenhead. Licence Number LA100018817. 2009.</small></p>		<p>Area: 0.299 hectares</p>	<p>Windsor & Maidenhead</p>

Appendix 1: Site Maps

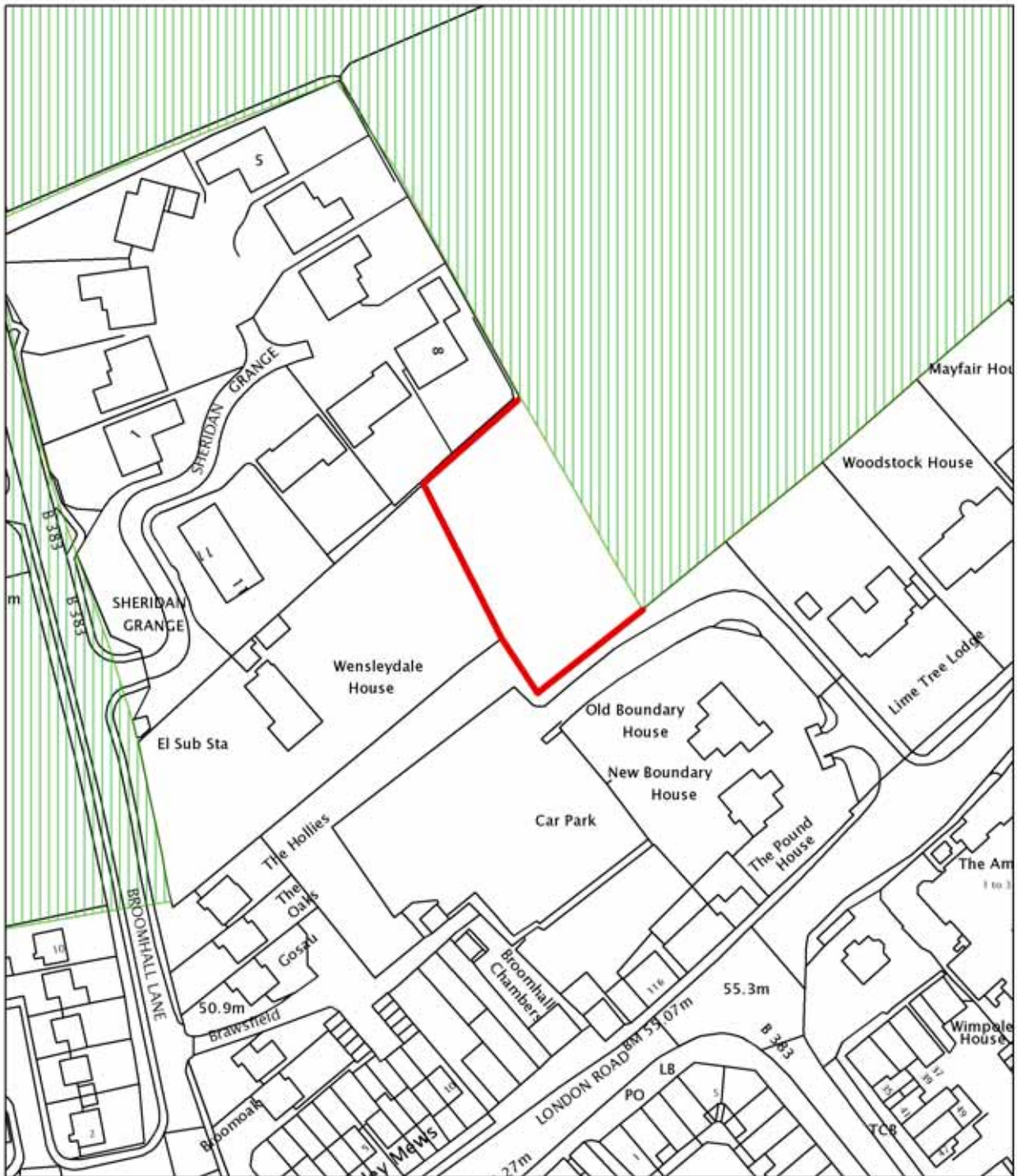

<p>Planning</p> <p>Scale: 1:1,250</p>		<p align="center">Location SD4 Land east of Broomhall Lane Sunningdale</p> <p align="center">Area: 0.198 hectares</p>	<p align="center">The Royal Borough Windsor & Maidenhead</p>
<p><small>This map is reproduced from Ordnance Survey material with the permission of Ordnance Survey on behalf of the Controller of Her Majesty's Stationery Office © Crown copyright.</small></p> <p><small>Unauthorised reproduction infringes Crown copyright and may lead to prosecution or civil proceedings. Royal Borough of Windsor and Maidenhead. Licence Number LA100018817. 2009</small></p>			

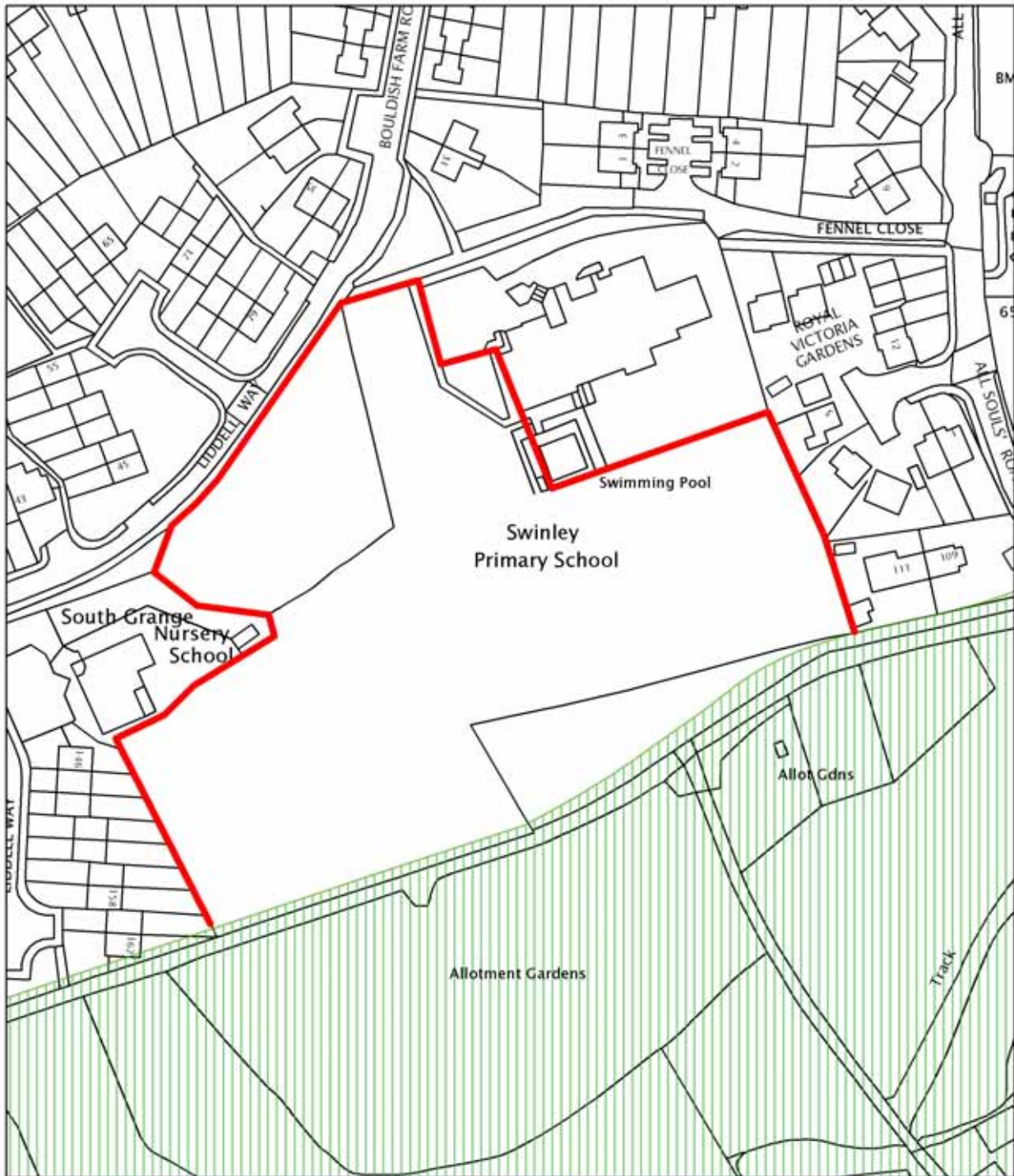

Appendix 1: Site Maps

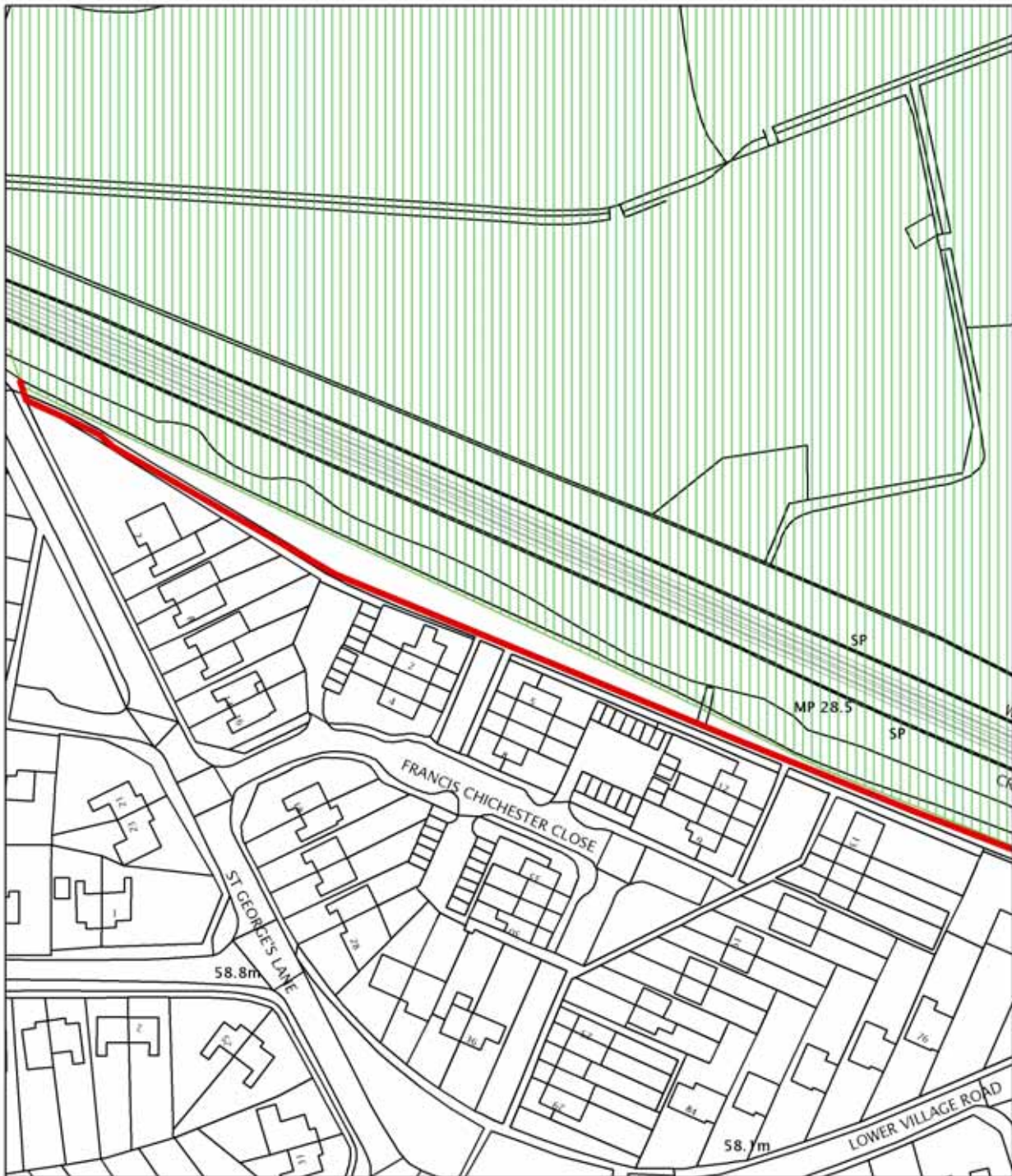

<p>Planning</p> <p>Scale: 1:1,250</p>	<p>N</p> 	<p>Location SH1 South Ascot Primary School Playing Fields, Ascot</p>	
<p><small>This map is reproduced from Ordnance Survey material with the permission of Ordnance Survey on behalf of the Controller of Her Majesty's Stationery Office © Crown copyright.</small></p> <p><small>Unauthorised reproduction infringes Crown copyright and may lead to prosecution or civil proceedings. Royal Borough of Windsor and Maidenhead. Licence Number LA100018817. 2009.</small></p>		<p>Area: 1.60 hectares</p>	<p>Windsor & Maidenhead</p>

Appendix 1: Site Maps



<p>Planning</p> <p>Scale: 1:1,250</p>		<p>Location SH2 Land north of Francis Chichester Close Sunninghill</p>	
<p><small>This map is reproduced from Ordnance Survey material with the permission of Ordnance Survey on behalf of the Controller of Her Majesty's Stationery Office © Crown copyright.</small></p> <p><small>Unauthorised reproduction infringes Crown copyright and may lead to prosecution or civil proceedings. Royal Borough of Windsor and Maidenhead. Licence Number LA100018817. 2009</small></p>			

Appendix 1: Site Maps

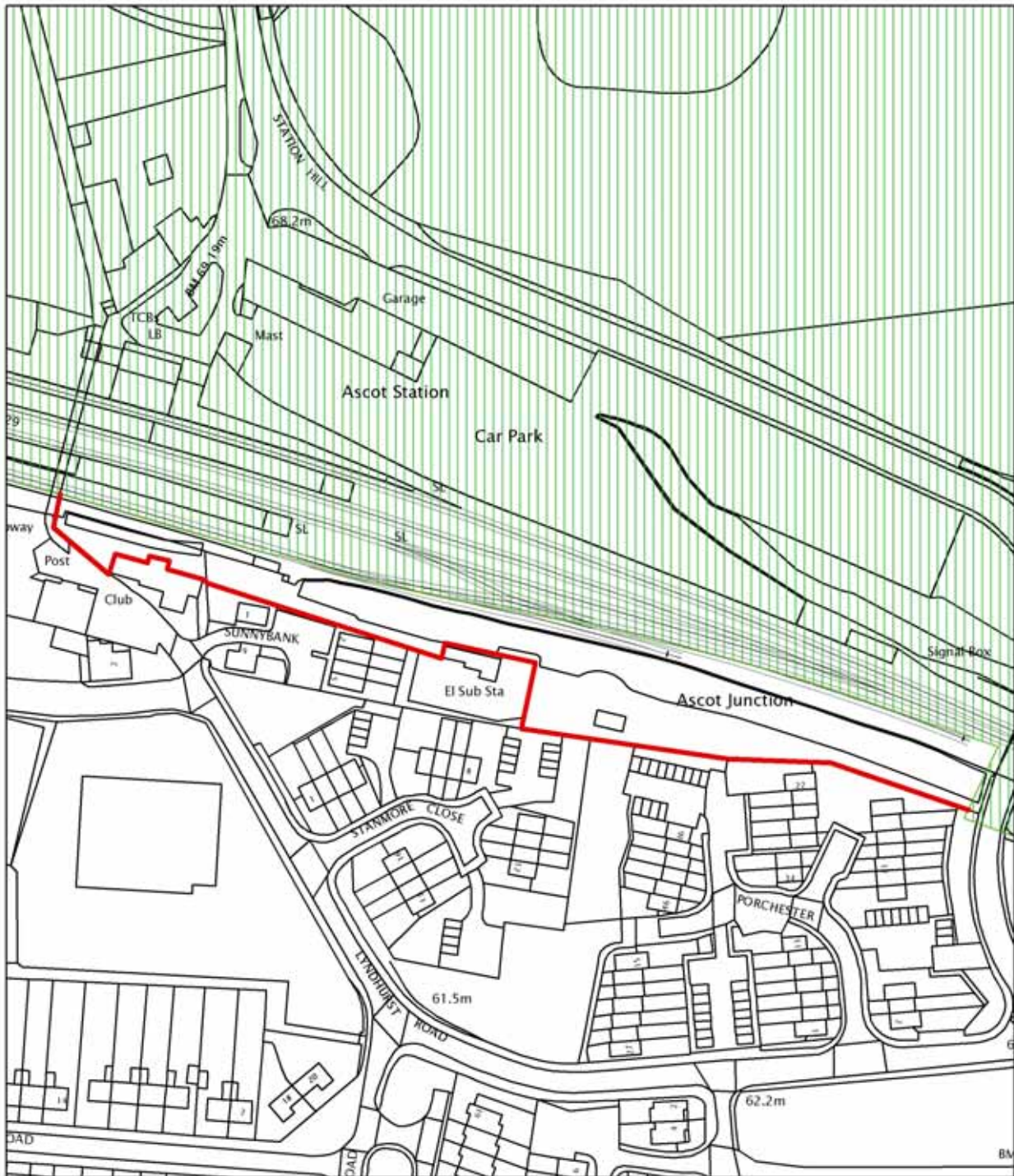

<p>Planning</p> <p>Scale: 1:1,500</p>		<p style="text-align: center;">Location SH3 Land south of Ascot Station, South Ascot</p> <p style="text-align: center;">Area: 0.578 hectares</p>	<p style="text-align: center;">The Royal Borough Windsor & Maidenhead</p>
<p><small>This map is reproduced from Ordnance Survey material with the permission of Ordnance Survey on behalf of the Controller of Her Majesty's Stationery Office © Crown copyright.</small></p> <p><small>Unauthorised reproduction infringes Crown copyright and may lead to prosecution or civil proceedings. Royal Borough of Windsor and Maidenhead. Licence Number LA100018817. 2009.</small></p>			